



**"Modern Coastal" Elevation**

~ Available In Several Front Elevation Styles ~  
Gold Coast Custom Homes Has Perfected The Process Of Delivering High Quality Custom Homes For Our Clients. Our Barbados Plan Is One Of Our Wider Lot Homes. With 2543 Living Sqft, This Meticulously Designed 3 Bedroom, 3 Bath With Study Is Our Most Popular Layout Featuring A Spaciously Open Great Room Layout Perfect For Today's Active Life Style. All Our Homes INCLUDE Many Upgrades Standard: 11'-12'+ Ceilings In The Main Areas, (3) Tray Ceilings, Brick Pavers, Large Island In Kitchen, High Quality Tile In Main Areas, Custom 42" Maple Cabinetry W. Crown Molding & Light Rail In The Kitchen, Plus Much, Much More! Call Today To Discuss The Next Steps In Building Your Dream Home.



**"Mediterranean" Elevation**



**"West Indies" Elevation**



# "The Barbados Plan"

386.313.6221

[www.GoldCoastCustomHomes.com](http://www.GoldCoastCustomHomes.com)



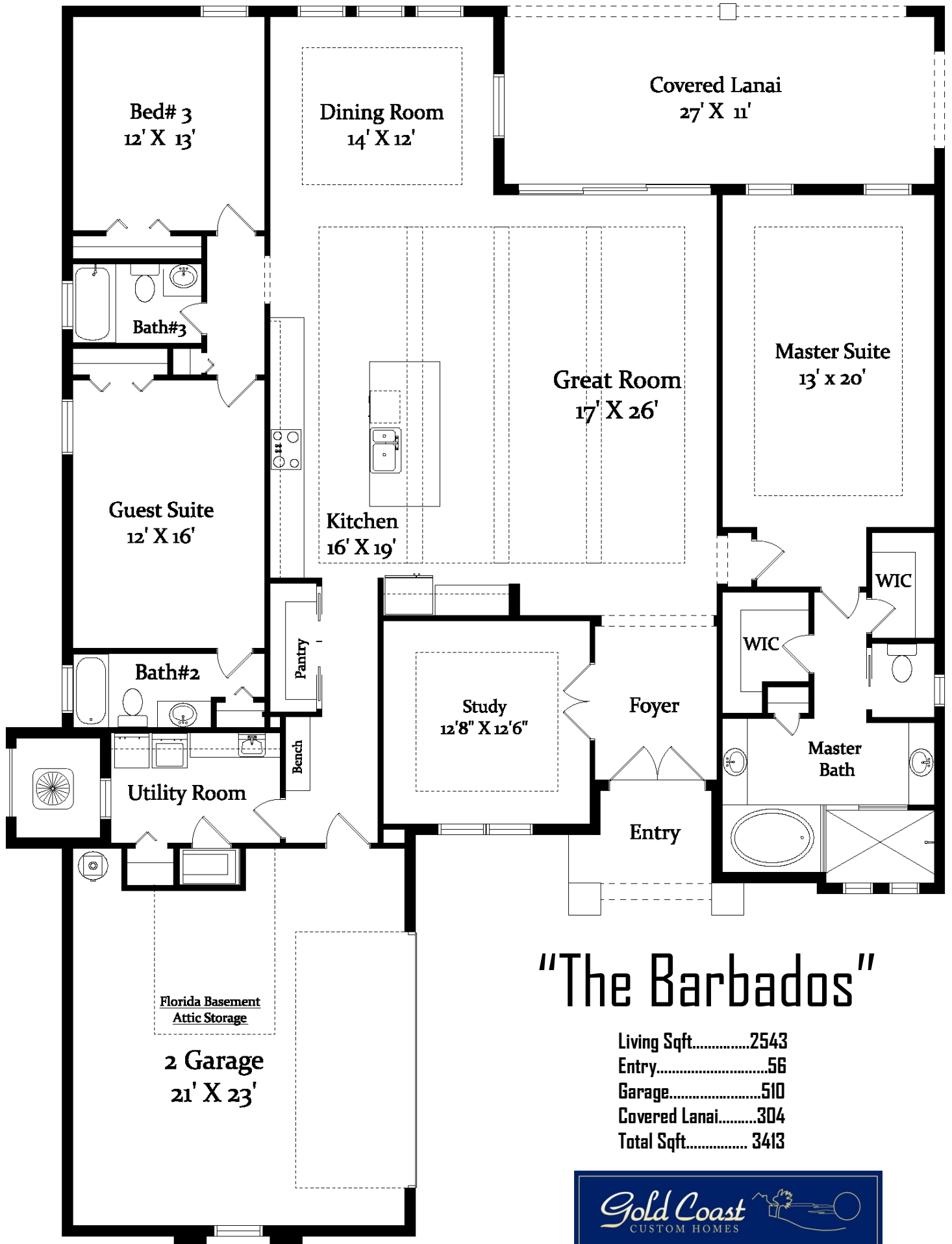

# "The Barbados"

Living Sqft.....	2543
Entry.....	56
Garage.....	510
Covered Lanai.....	304
<b>Total Sqft.....</b>	<b>3413</b>



CGC1507791 Gold Coast Custom Homes © 2023 All Photographs, elevation renderings, floor plans and square footages are for representation purposes only and may not reflect the exact dimensions or features of your home. All dimensions, floor plans, elevations, square footages, features, specifications, prices and product types are subject to change without notice or obligation. All Gold Coast Custom Homes floor plans and elevations may be subject to copyright protection. Any reproduction or use of this brochure material without written permission from Gold Coast Custom Homes is strictly prohibited.