



"West Indies" Elevation

~ Available In Several Front Elevation Styles ~
Gold Coast Custom Homes Has Perfected The Process Of Delivering High Quality Custom Homes For Our Clients. Our "Palm Beach" Plan Features A Formal Dining Room With An Open Great Room Layout. With 2500 Living Sqft, This Well Designed 3 Bedroom 3 Bath With Study Features Is Ideal For A Wider Property. All Our Homes INCLUDE Many Upgrades Standard: 11'-12'+ Ceilings In The Main Areas, (3) Tray Ceilings, Brick Pavers, Large Island In Kitchen, High Quality Tile In Main Areas Of Home, Custom 42" Maple Cabinetry W. Crown Molding, Light Rail In The Kitchen, Plus Much, Much More! Call Today To Discuss The Next Steps in Building Your Dream Home.



"Portofino" Elevation



"Florida" Elevation



"The Palm Beach Plan"

386.313.6221

www.GoldCoastCustomHomes.com

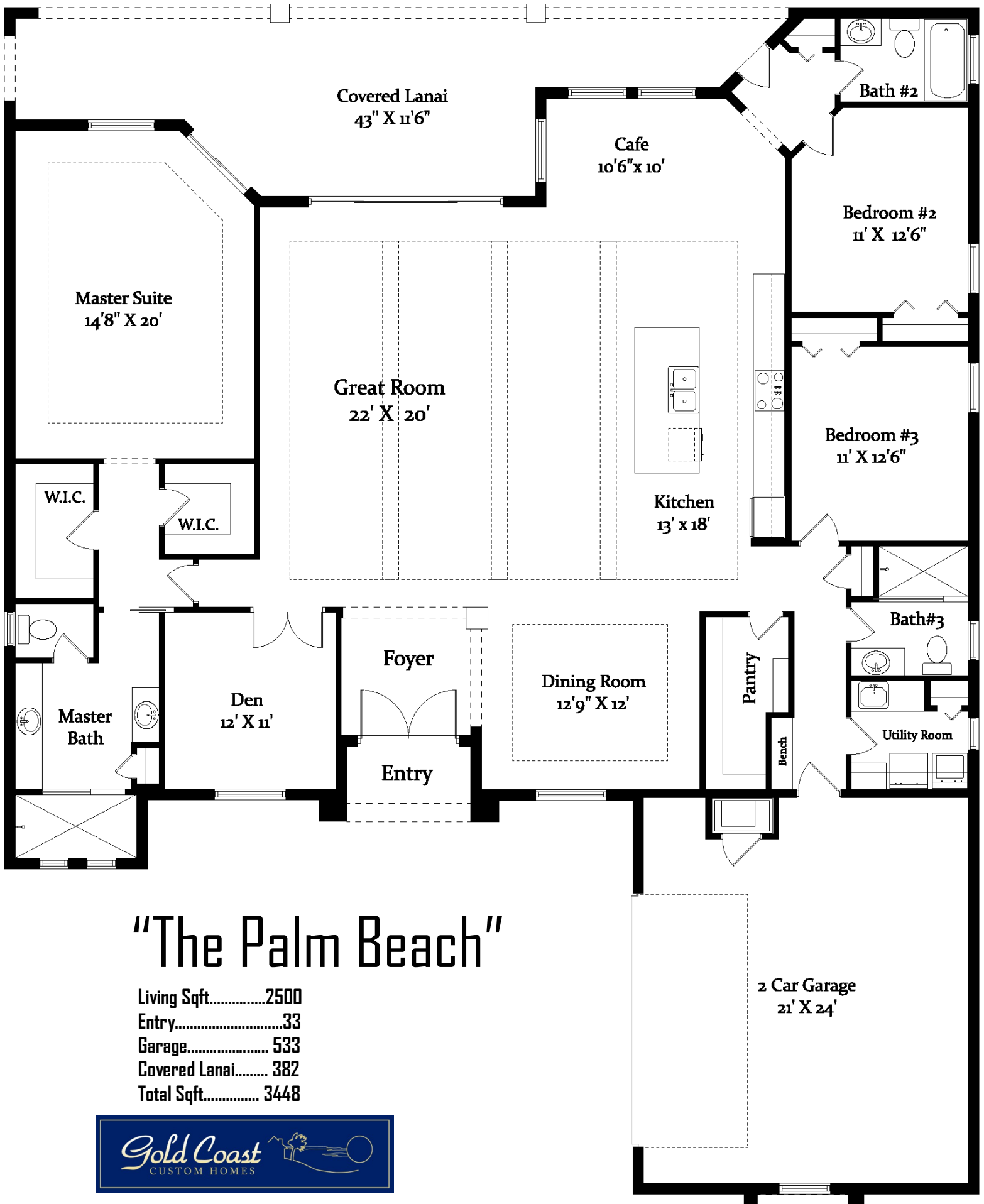

"The Palm Beach"

Living Sqft.....2500
 Entry.....33
 Garage..... 533
 Covered Lanai..... 382
 Total Sqft..... 3448

