



"West Indies" Elevation

~ Available In Several Front Elevation Styles ~
Gold Coast Custom Homes Has Perfected The Process Of Delivering High Quality Custom Homes For Our Clients. Our Augusta Plan Is One Of Our Favorite Plans. With 2202 Living Sqft, This Great Room Open Design Is 3 Bedrooms 2 Baths With A Study.
Our Homes INCLUDE Many Upgrades: 11'-12'+ Ceilings (3) Tray Ceilings, Brick Pavers, Large Island In Kitchen, High Quality Tile In Main Areas Of Home, Custom 42" Maple Cabinetry W. Crown Molding, Light Rail In The Kitchen Plus Much, Much More!
Call Today To Discuss The Next Steps In Building Your Dream Home.



"Portofino" Elevation



"Florida" Elevation



"The Augusta Plan"

386.313.6221

www.GoldCoastCustomHomes.com

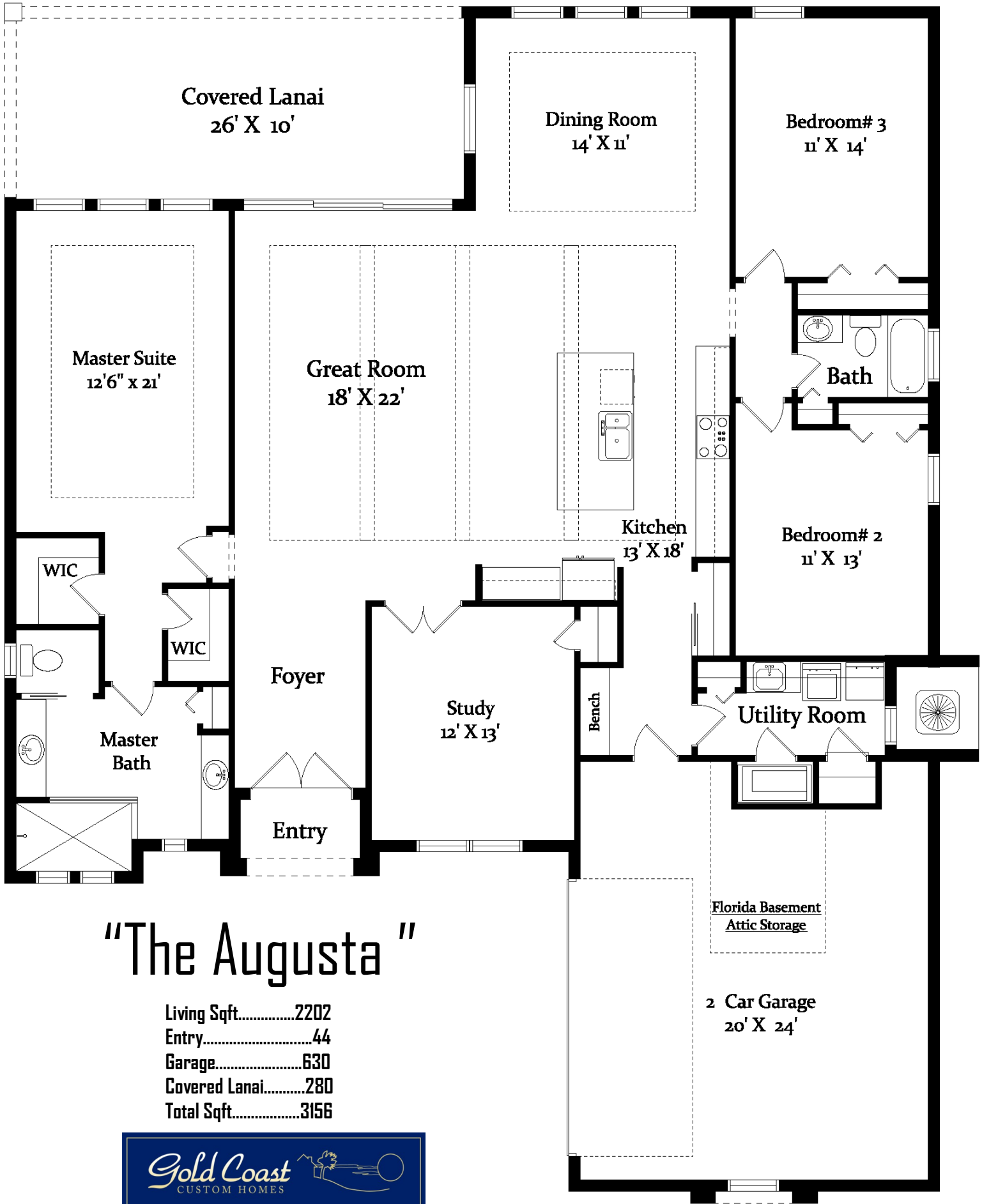

"The Augusta"

Living Sqft.....2202
 Entry.....44
 Garage.....630
 Covered Lanai.....280
 Total Sqft.....3156



Florida Basement
Attic Storage

2 Car Garage
20' X 24'